

HIGH TORQUE HYBRID STEPPING MOTOR SPECIFICATIONS

| General specifications | | Electrical specifications | |
|-------------------------------------|------------------------------------|---|------------|
| Step Angle (°) | 1.2 | Rated Voltage (V) | 5.22 |
| Temperature Rise (°C) | 80 Max (rated current, 2 phase on) | Rated Current (A) | 5.8 |
| Insulation Resistance (°C) | -20~+50 | Resistance Per Phase ($\pm 0\% \Omega$) | 0.9 (25°C) |
| Number of Phase | 3 | Inductance Per Phase ($\pm 20\% \text{mH}$) | 3.2 |
| Insulation Resistance (M Ω) | 100 Min (500VDC) | Holding Torque (N.m) | 4.52 |
| Insulation Class | Class B | Detent Torque (N.m) | 0.4 |
| Max.radial force (N) | 220 (20mm from the flange) | Rotor Inertia (g. cm ²) | 2320 |
| Max.axial force (N) | 60 | Weight (Kg) | 3.0 |

● Wiring Diagram:

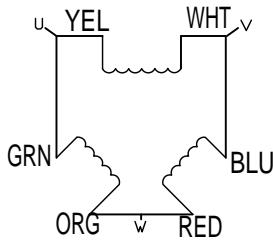

● Pull out torque curve:

VOLTAGE: 220VAC, CONSTANT CURRENT:5.8A,MS-3H110M START SHAPHON STEP DRIVER HLAF STEP

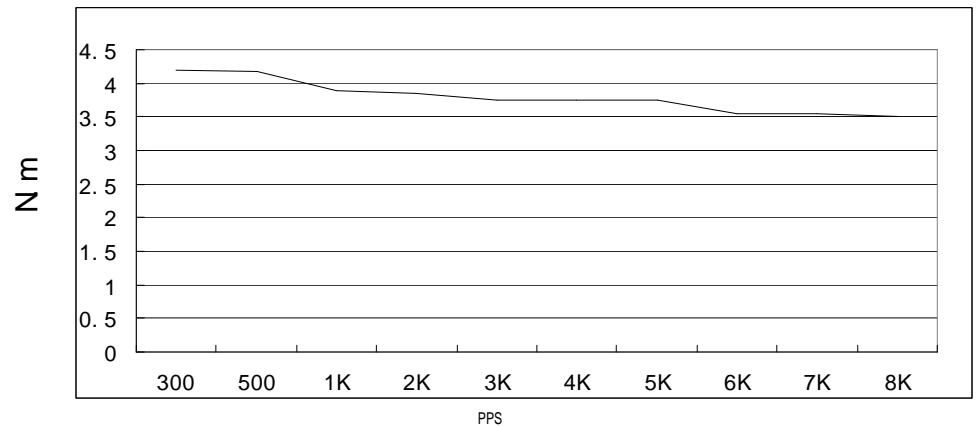

● Dimensions:
(unit=mm)

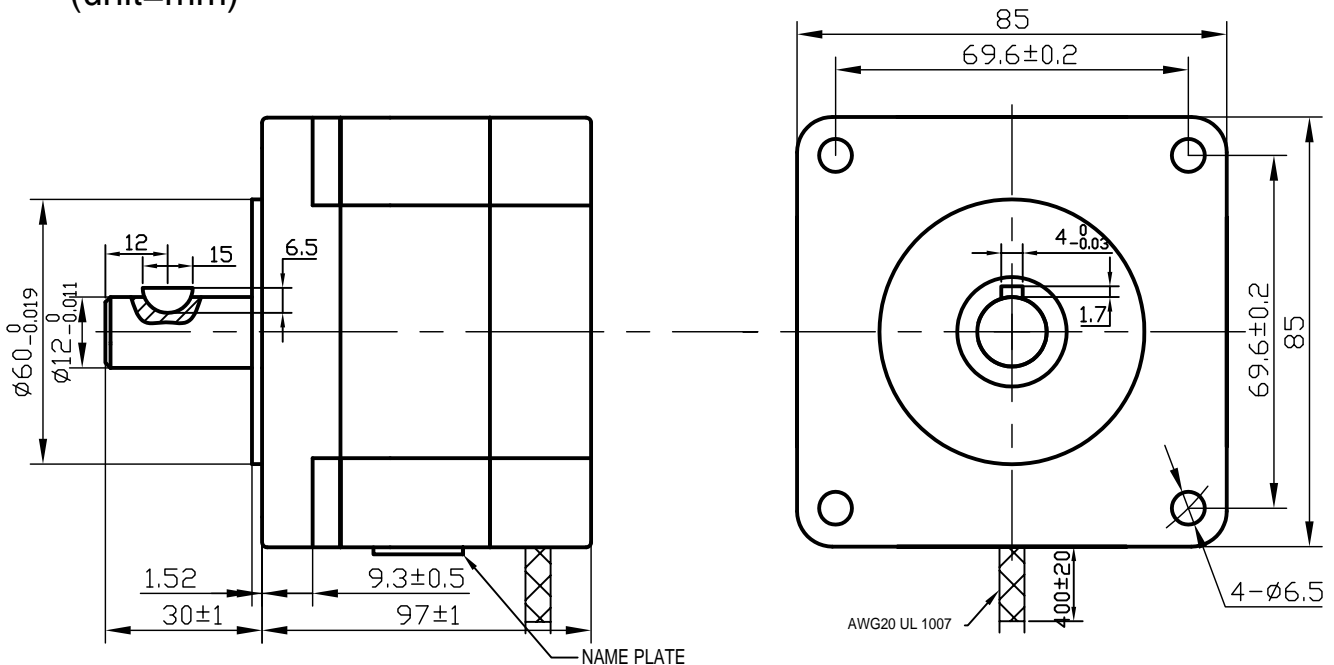

| | | | | | | |
|---------|-----------|-------------|----|------|---|----------------------|
| △ | | | | | SY853P97-5806A | TECHNICAL CONDITIONS |
| △ | | | | | | |
| REV | REVISIONS | DESCRIPTION | BY | DATE | CHANGZHOU SONGYANG MACHINERY & ELECTRONICS NEW TECHNIC INSTITUTE | 120097001 |
| DRAW | 董宝军 | | | | | |
| CHECK | | | | | | |
| APPROVE | | | | | | |