

- Notes:
1. Pitch: 6.35mm
  2. Rated volatge/current:UL 300V/30A VDE 450V/32A
  3. Insulation resistance: 5000MΩ/DC1000V
  4. Withstanding voltage: AC2000V/1Min
  5. Wire range: 26-10 AWG 4mm<sup>2</sup>
  6. Temp. range: -40° C~+105° C
  7. Torque: 5.10kgf.cm
  8. Undimensioned Tolerances:

Pitch range in mm	Nominal dimension range in mm					
	over 6	over 10	over 30	over 60	over 100	over 150
to 6	to 10	to 24	to 30	to 60	to 100	to 150
±0.10	±0.15	±0.25	±0.2±0.3	±0.5±0.7	±1.0	±1.0

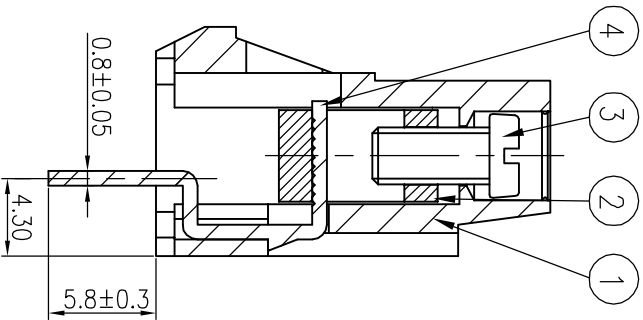

截面 A-A

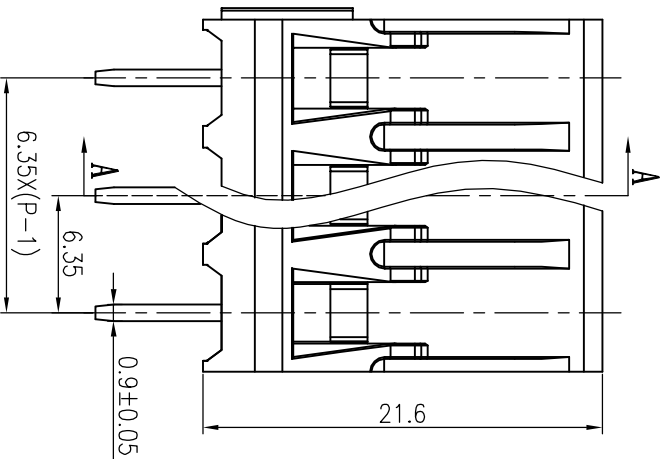
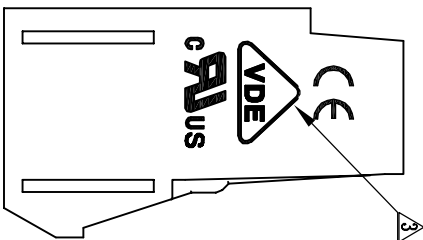
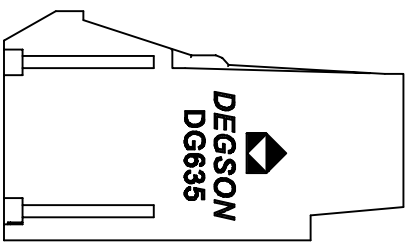

REVISION RECORD			
REV	ECO	DESCRIPTION	DATE
1		Drawing Revise	03/27/06
2		增加U1刻字	10/04/06
3		增加VDE、CE标志	11/09/07
4		增加VDE参数	01/09/08

4	DG635-Pin header	4030B00010(H)	XX	Brass	Sn/Ce
3	DG350"-Screws	S000001690(H)	XX	Steel	C <sup>4</sup> Zn
2	DG350 Cage	X000000310(H)	XX	Brass	Ni plated

1	DG635-6.35 Housing	4030A07XXA(H)	1	PAGE	UL94V-0
ITEM NAME OF PART		NO. OF PART	Q'TY	MATERIAL	NOTES
DETACHED LISTS					
TOLERANCES EXCEPT AS NOTED		DFTO HOUH			
MM	0 ±	DATE	05/07/05	DATE	
MM	0.00 ±	MFO		DATE	
MM	0.00 ±	APPL		DATE	
ANGLES ± 1°		MATERIAL :			
THIRD ANGLE PROJECTION		G.E. :			
		FINISH :			
		SCALE : 1:1			
		NAME			
		DG635-6.35-XXP-1Y-00A(H)			
		DRAWING NO. DG635-6.35-E01			
		/PART NO.			
		DO NOT SCALE DRAWING			
		SHEET 1 OF 1			

8 7 6 5 4 3 2 1